



Poodle, the interactive puppy, is a new type of friend! She expresses her emotions through her bright expressive eyes, swinging ears and wagging tail. Enjoy hours of playful singing, fun dancing and real puppy sounds. She uses advanced technology to create realistic emotional responses that adapt and change as you play with her. The more you play with her, the happier she becomes – she may even sing a special song for you!

CHECKLIST

The following items are included in this package:

- 1 – Poodle, the Interactive puppy
- 1 – Poodle's bone
- 1 – Instruction manual

If anything is missing, please contact the Tiger Electronics' Customer Service department and they will send you the missing item.

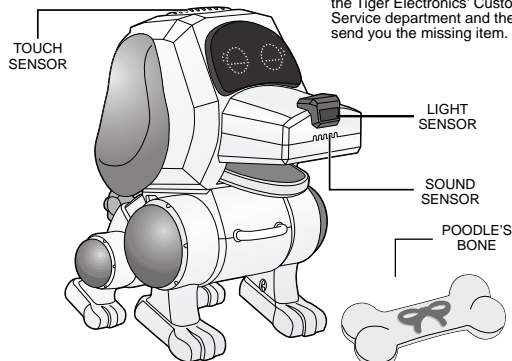

BATTERY INSTALLATION

IMPORTANT: Battery installation should be done by an adult. Always install the batteries correctly according to the positive (+) and negative (-) signs on the batteries.

1. Unscrew and remove the battery compartment door on the back of Poodle's head.
2. Insert 3 "AAA"/LR03 batteries as shown inside the battery compartment.
3. Attach the battery compartment door and fasten the screw.
4. Press the **RESET** button located on upper jaw outside Poodle's mouth (see **RESET** section for more details).

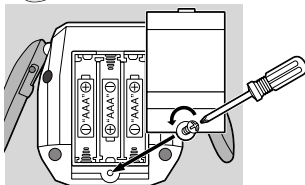

* Do not dispose of batteries in fire, batteries may explode or leak.

NOTE: Your Poo-Chi Friend will begin to move as soon as you install the batteries. There is no ON/OFF switch. To turn the unit off, either remove the batteries or see the section entitled "**SLEEPING.**"

HELPFUL TIP: Your Poo-Chi Friend is a mechanical, robotic toy. The mechanical sound you hear when it moves is normal.

To ensure proper function:

- Do not mix old and new batteries.
- Do not mix alkaline, standard or rechargeable batteries.
- Battery installation should be done by an adult.
- Non-rechargeable batteries are not to be recharged.
- Rechargeable batteries are to be removed from the toy before being charged (if removable).
- Rechargeable batteries are only to be charged under adult supervision. (if removable).
- Only batteries of the same or equivalent type as recommended are to be used.
- Batteries are to be inserted with the correct polarity.
- Exhausted batteries are to be removed from the toy.
- The supply terminals are not to be short-circuited.
- Replace with new batteries at the first sign of erratic operation.

CAUTION:

- As with all small batteries, the batteries used with this toy should be kept away from small children who still put things in their mouths. If they are swallowed, promptly see a doctor and have the doctor phone (202) 625-3333 collect.
- Make sure the batteries are inserted correctly and follow the toy and battery manufacturer's instructions.

SET UP

Your Poo-Chi Friend will play the best on a smooth, flat surface. Make certain that the area is clear of obstacles so she can stand, sit and dance on her tiptoes! Poodle should be played indoors.

SENSORS

Your Poo-Chi Friend is very unpredictable. Activate one of her sensors to see what she will do! She has three sensors: a light sensor in her eyes, sound sensor and touch sensor on her head.

To activate the **LIGHT** sensor:

- **WAIT** until she stops moving.
- Slowly pass your hand in front of her nose.
- When you move your hand away from her nose, she will respond.

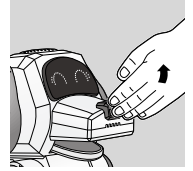

To activate the **SOUND** sensor:

- **WAIT** until she stops moving
- Simply clap your hands or make a loud sound, Poodle will respond.

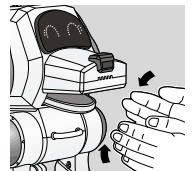

To activate the **TOUCH** sensor:

- **WAIT** until she stops moving
- Simply press the button on top of Poodle's head. If you press the head button once, Poodle will respond. If you press the head button twice, she will respond in a different way.

All Poo-Chi Friends love to play and be happy.

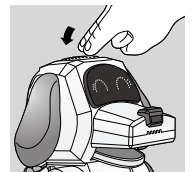

YOUR POO-CHI FRIEND'S EYES

Poodle's eyes are very expressive. Poodle's eyes will tell you if she is happy, sad, sleepy and that she loves you! Poodle can even blink!

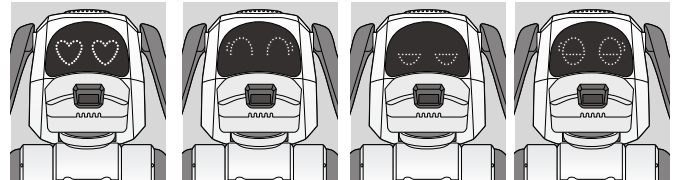

Very Happy Poodle

Happy Poodle

Sad Poodle

Blinking Poodle

POODLE'S BIORHYTHM

Graphs shown below represent the 8 biorhythm levels of your Poo-Chi Friend, Poodle. Each level lasts about 30 minutes and determines her feelings and behavior. For example, when Poodle is in level 1 she will be unhappy most of the time, and will probably have sad eyes. In level 8, she will be happy almost all of the time, and will sing you special songs!

Remember: If she is sad, it's very easy to make her happy again by playing with her. Don't forget, Poodle has three different sensors that need attention! (Refer to the **SENSORS** section).

Level 1: Poodle is very unhappy and needs much care and affection.

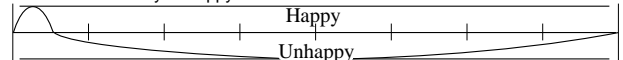

Level 2: Poodle is still sad, maybe feeding Poodle her bone will help!

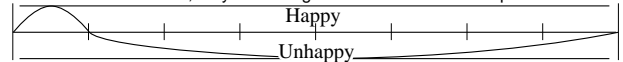

Level 3: Remember to watch Poodle's eyes, they tell you how she feels.

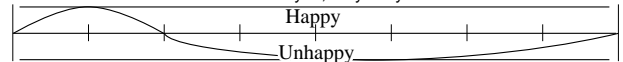

Level 4: Getting happier, Poodle loves to be petted!

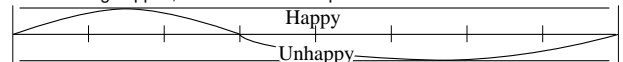

Level 5: Poodle hears when you clap or say "Good Dog!"

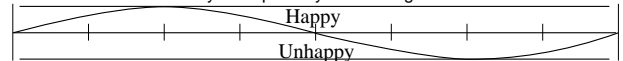

Level 6 (Home position): Poodle starts at this level when reset.

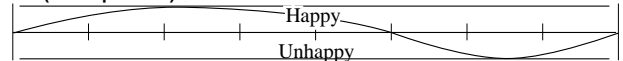

Level 7: Poodle's very happy, she might even sing you a special song!

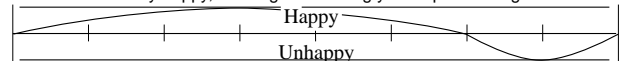

Level 8: Congratulations on being a World Class Owner, watch for her special tricks!

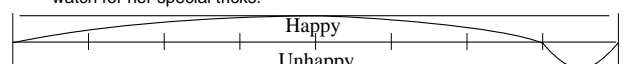

YOUR POO-CHI FRIEND'S BONE

Your Poo-Chi Friend loves to be cared for and the more you take care of her, the happier she will be. Feed Poodle by holding the middle of the bone in front of her mouth. Poodle will respond with happy eyes, wagging tail and a special eating sound.

- Do not place the bone INSIDE of her mouth – hold the bone in front of Poodle's mouth to simulate feeding. Poodle's bone does NOT require batteries. Do not attempt to open the bone.
- Avoid placing the bone close to any magnetic-sensitive object like a cassette tape, video tape, magnetic disk, credit card, etc.

WARNING: Poodle's bone is a toy. Poodle's bone is not intended for use by a live dog.

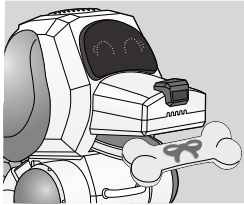

POO-CHI FRIENDS' EARS

Poodle's ears are designed to be re-attached should they become detached. Sometimes during shipping or while you are playing with Poodle, one of her ears may come off. If this happens, simply re-attach the ear by lining up both notches on the ear and hinge.

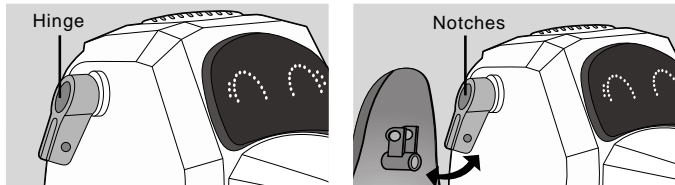

LISTEN TO A SONG

To listen to one of Poodle's favorite songs, please follow the sequence below:

1. Wait until Poodle stops moving.
2. Hold your hand completely over Poodle's nose.
3. While still holding your hand over Poodle's nose, press the head button 5 times quickly (you must press the head button 5 times within 2 seconds).
4. Wait until you hear 3 short beeps, remove your hand, then quickly press the head button again for 1 – 6 times and you will hear a different song for each number of beeps.
5. After each song is finished, Poodle will return to her normal mode. To hear another song, begin with Step 1 above.

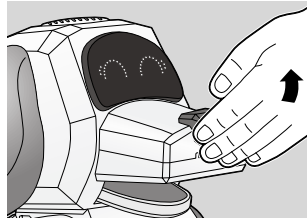

SLEEPING

Because Poodle is a puppy, she needs her sleep. Just like a real puppy, she will fall asleep when it is dark or when no one is playing with her. When Poodle gets tired, she will sit down and her eyes will flash and close. You may even hear a little snore!

Sometimes it takes Poodle a long time to fall asleep. First, she will make noises to try to get your attention. Her eyes may even start to flash depending on her mood. If she doesn't get your attention after 6 minutes, she will sit down and snore. If she still doesn't get your attention after the snoring, she will fall into a deep sleep.

To wake up Poodle when she is in a deep sleep, press her head button. If Poodle was sad when she fell asleep, it may take her a little while to completely wake up so you may need to press her head button more than once. If she was happy when she fell asleep, she will quickly wake up.

COMMUNICATING WITH OTHER ROBO-CHI™ PETS

Poodle will communicate with other Poo-Chi Friends and Robo-Chi pets. To begin communication, please follow the sequence below:

1. Place the two animals so they face each other and are approximately 6" – 12" apart.
2. Wait for both creatures to stop moving.
3. Press the head button ONCE on BOTH CREATURES at the SAME TIME.
4. The dogs will begin to speak. If they like each other, they will sing a song together. If they don't like each other they will growl at one another.
5. Both will automatically return to normal play mode after they communicate for approximately 2 minutes. If you want the animals to communicate again, begin with Step 1 above.

RESET

Press the **RESET** button only if Poodle's movements seem to be malfunctioning.

To press the **RESET** button, turn Poodle upside down and press the **RESET** button located on the outside of her upper jaw. Press the **RESET** button once with a ball-point pen. Do not press the **RESET** button with any instrument.

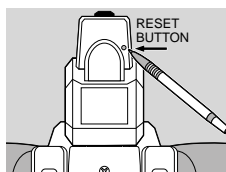

CLEANING INSTRUCTIONS



High temperature will destroy the unit. Do not leave unit in direct sunlight.

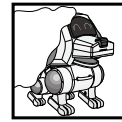

Clean only with a piece of soft dry cloth.

TROUBLESHOOTING

Your Poo-Chi Friend is designed to provide hours of fun play. If her actions become erratic and you are having trouble, check to make certain that Poodle has fresh batteries and then call Tiger Electronics' Customer Service Department at 1-800-844-3733

If you can't see Poodle's eyes, she may be asleep (see section entitled "SLEEPING") or check to make certain there are fresh batteries.

You can wake up Poodle by pressing the head sensor. If she was sad when she fell asleep, it may take multiple head presses to wake up Poodle. If she was happy when she fell asleep, it will be easier to wake her up.

To wake up Poodle when she is snoring, hold her special bone in front of her mouth or press her head button.

For more information about Tiger Electronics, our products and special promotions, please visit our web site at: www.tigertoys.com.

90-DAY LIMITED WARRANTY

Tiger Electronics, Ltd. (TIGER) warrants to the original consumer purchaser of this product that the product will be free from defects in materials or workmanship for 90 days from the date of original purchase. This warranty does not cover damages resulting from accident, negligence, improper service or use or other causes not arising out of defects in materials or workmanship.

During this 90-day warranty period, the product will either be repaired or replaced (at TIGER'S option) without charge to the purchaser, when returned with proof of the date of purchase to either the dealer or to TIGER.

Product returned to TIGER without proof of the date of purchase or after the 90-day warranty period has expired, but prior to one year from the original date of purchase, will be repaired or replaced (at TIGER'S option) for a service fee of US\$17.00. Payments must be by check or money order payable to Tiger Electronics, Ltd.

THE FOREGOING STATES THE PURCHASER'S SOLE AND EXCLUSIVE REMEDY FOR ANY BREACH OF WARRANTY WITH RESPECT TO THE PRODUCT.

All product returned must be shipped prepaid and insured for loss or damage to:

TIGER REPAIR DEPARTMENT
1000 N. Butterfield Road, Unit 1023
Vernon Hills, IL 60061, U.S.A.

The product should be carefully packed in the original box or other packing materials sufficient to avoid damage during shipment. Include a complete written description of the defect, a check if product is beyond the 90-day warranty period, and your printed name, address and telephone number.

THIS WARRANTY IS IN LIEU OF ALL OTHER WARRANTIES AND NO OTHER REPRESENTATIONS OR CLAIMS OF ANY NATURE SHALL BE BINDING ON OR OBLIGATE TIGER IN ANY WAY. ANY IMPLIED WARRANTIES APPLICABLE TO THIS PRODUCT, INCLUDING WARRANTIES OF MERCHANTABILITY AND FITNESS FOR A PARTICULAR PURPOSE, ARE LIMITED TO THE NINETY (90) DAY PERIOD DESCRIBED ABOVE. IN NO EVENT WILL TIGER BE LIABLE FOR ANY SPECIAL, INCIDENTAL, OR CONSEQUENTIAL DAMAGES RESULTING FROM POSSESSION, USE, OR MALFUNCTION OF THIS TIGER PRODUCT.

Some states do not allow limitations as to how long an implied warranty lasts and/or exclusions or limitations of incidental or consequential damages, so the above limitations and/or exclusions of liability may not apply to you. This warranty gives you specific rights, and you may also have other rights which vary from state to state.

This device complies with Part 15 of the FCC Rules. Operation is subject to the following two conditions :

- (1) this device may not cause harmful interference, and (2) this device must accept any interference received, including interference that may cause undesired operation.

Warning: Changes or modifications to this unit not expressly approved by the party responsible for compliance could void the user's authority to operate the equipment.

NOTE: This equipment has been tested and found to comply with the limits for a Class B digital device, pursuant to Part 15 of the FCC Rules. These limits are designed to provide reasonable protection against harmful interference in a residential installation. This equipment generates, uses, and can radiate radio frequency energy and, if not installed and used in accordance with the instructions, may cause harmful interference to radio communications. However, there is no guarantee that interference will not occur in a particular installation. If this equipment does cause harmful interference to radio or television reception, which can be determined by turning the equipment off and on, the user is encouraged to try to correct the interference by one or more of the following measures:

- Reorient or relocate the receiving antenna.
- Increase the separation between the equipment and receiver.
- Connect the equipment into an outlet on a circuit different from that to which the receiver is connected.
- Consult the dealer or an experienced radio TV technician for help.

TIGER
ELECTRONICS
A division of Hasbro, Inc.



©, TM, & © 2001 Tiger Electronics, Ltd. All Rights Reserved.
980 Woodlands Parkway, Vernon Hills, Illinois 60061, U.S.A.
©, TM, & © 2001 Tiger Electronics UK Ltd. All Rights Reserved.
Belvedere House, Victoria Avenue, Harrogate, North Yorkshire, United Kingdom HG1 1EL.

© SEGA TOYS 2001
PRINTED IN CHINA

200102950IWTI-01